



INDEC1500P3 TECHNICAL DATA

TECHNICAL SPECIFICATIONS

NOMINAL AIRFLOW		HEAT EXCHANGER <small>*RATED AT STANDARD CONDITIONS OF 40.0° db/20.3° wb</small>	
Supply Air (l/sec)	1500	INDEC Counterflow Core	1
Exhaust Air (l/sec)	550	Nominal Cooling Capacity (kw)*	20
Total Intake Fresh Air (l/sec)	2050	Pressure Drop (Pa)	38.5
SUPPLY FAN		CABINET CONSTRUCTION	
Fan Type	EC Plug	Casing	50mm Colourbond Panel
Fan Motor	EC Motor	Side Access Panels	Included
Motor Power (Watts)	2825	Exhaust Air Grille	Included
Max. External Static (Pa)	250	Exhaust Balancing Damper	Included
Fan Diameter	450	WATER SUPPLY	
Number of Fans	1	Water Pump	2
ELECTRICAL		Nominal Water Usage	30 Lph
Supply Fan FLA (A)	5.2 - 5.2 - 5.2	Water Inlet	12mm
Volt/Phase	415V/3ph	Inline Filter	Included
Circuit Breakers	Yes	Water Treatment Salinity Control	Included
CONTROLS		Stainless Steel Sump	Included
0-10V DC (Fan Control)	Included	Automatic Sump Dump	Included
24V AC Control Relay	Included	Drain Outlet	40mm PVC
Pump Relay	24V x 2	Secondary Overflow Drain	25mm
Water Valve Relay	24V	OPTIONAL INLET FILTER PLENUM	
BMS Capability	Included	Weatherproof louvre grille	Included
Wall Controller	Available	Air filters - G4 disposable	2 - 595 x 595 x 50



TECHNICAL DRAWINGS INDEC1500P3 STANDARD UNIT

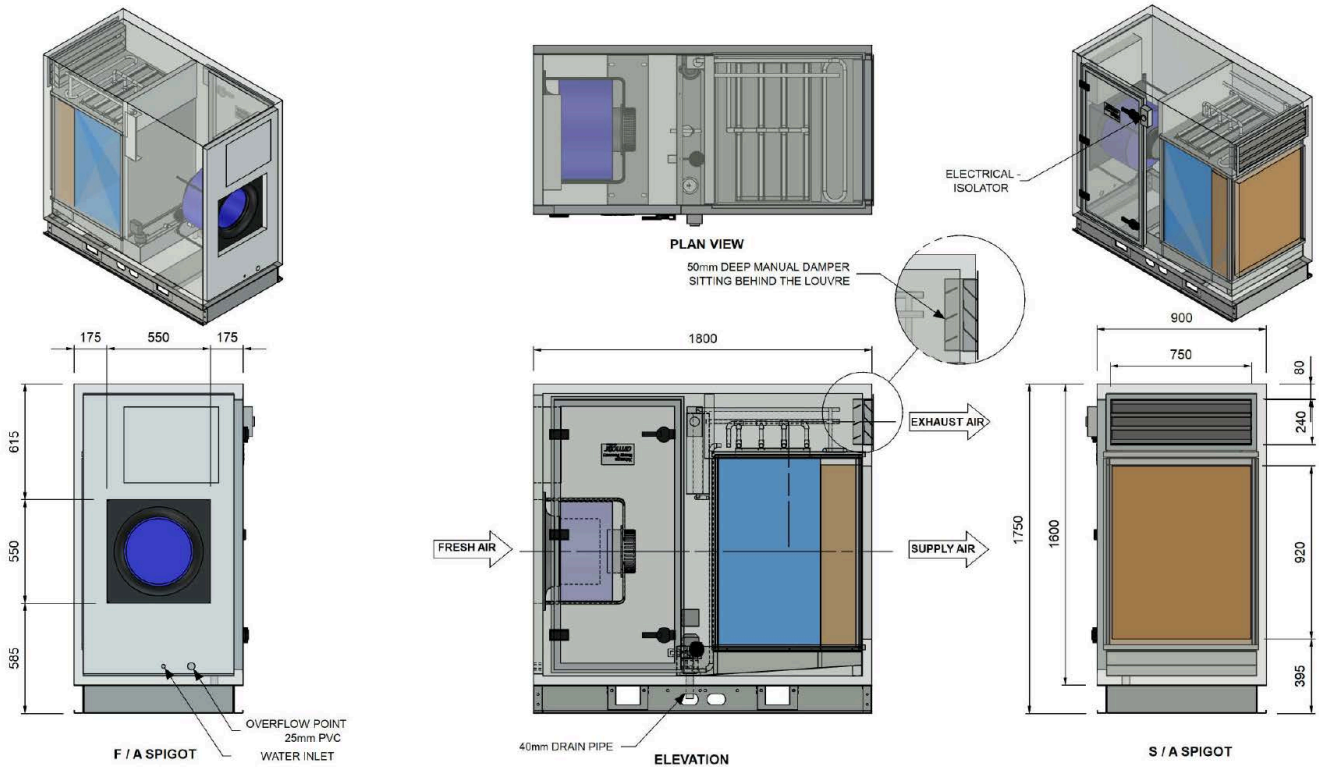

DIMENSIONS	
Height (mm)	1750
Width (mm)	900
Length (mm)	1800
Weight (Kg)	320
Operating Weight (Kg)	380
Access Clearance (mm)	1200 (Fan Access One Side)

DUCT SIZES	
Supply Air (mm)	750 x 920
Inlet Fresh Air (mm)	750 x 1200
Recommended Min Filter Size	600 x 1200



TECHNICAL DRAWINGS INDEC1500P3 WITH INLET FILTER PLENUM

DIMENSIONS		DUCT SIZES	
Height (mm)	1750	Supply Air (mm)	70 x 920
Width (mm)	900		
Length (mm)	23 0 (Including Inlet Plenum)		
Weight (Kg)	370		
Operating Weight (Kg)	430		
Access Clearance (mm)	1200 (Fan Access One Side)		



FAN PERFORMANCE DATA

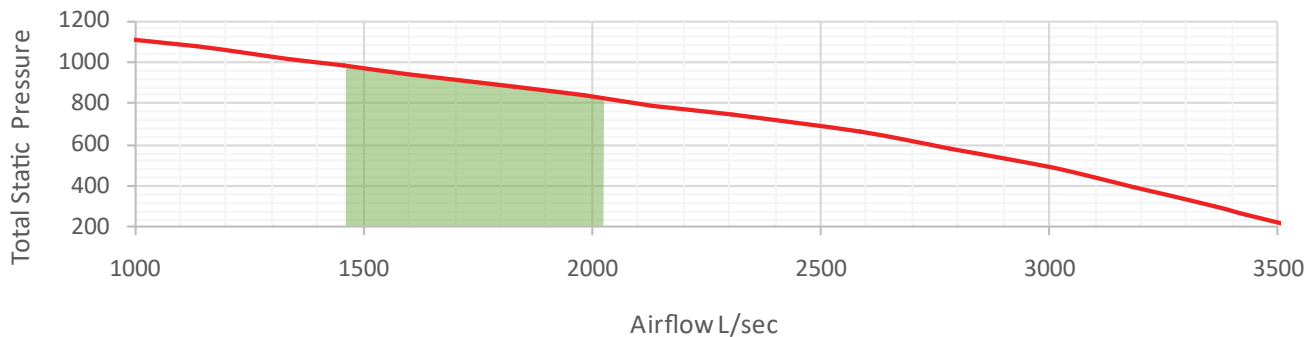

SOUND POWER LEVELS*

INLET RATING dB		OUTLET RATING dB	
63 Hz	68.9	63 Hz	69.5
125 Hz	76.6	125 Hz	75.9
250 Hz	76.3	250 Hz	74.8
500 Hz	72.8	500 Hz	76.8
1K Hz	71.8	1K Hz	78.3
2K Hz	71.1	2K Hz	75.0
4K Hz	68.1	4K Hz	70.9
8K Hz	64.5	8K Hz	66.2
LwA	77.7	LwA	81.9

* Sound Power Levels @ 350 Pa Total Static Pressure and 2000 l/s Total Air Volume measured at 1.0 m distance from fan axis.

WIRING DIAGRAM

Designed and manufactured in Australia

Armcor Air Solutions

109-111 Northcorp Blvd, Broadmeadows 3047

P 1800 244 556 E sales@armcor.com.au

www.armcor.com.au

