

ERV-PAC Packaged Airconditioning

XES Swim Pool Unit

XES900P3 Technical Data



Technical Specifications

Nominal Airflow

Supply Air (l/sec)	700 – 900
Return Air (l/sec)	700 – 900
Fresh Air (l/sec)	700 – 900
Condensor Air (l/sec)	540
Exhaust Air (l/sec)	1440

Supply Fan

Fan Type	EC Plug Fan
Motor Power (Watts)	1900
External Static (Pa)	250
Fan Diameter	355
Number of Fans	1

Exhaust Fan

Fan Type	EC Plug Fan
Motor Power (Watts)	1900
External Static (Pa)	250
Fan Diameter	355
Number of Fans	1

Electrical

*Max FLA to be used to size supply cables and relevant safety devices

Compressor Type	Fixed Speed	Inverter
Total Run Current (A)	14.2 - 14.2 - 14.2	11.9 - 11.9 - 11.9
Maximum Full Load (A)	20.4 - 20.4 - 20.4	29.8 - 29.8 - 29.8
Power Supply (V/Ph/Hz)	415/3/50	415/3/50

Controls

0-10V DC (Fan Control)	Included
24V AC Control Relays	Included
Fan Fault Signal	Included
Fan Status	Available
Switchboard	Yes
Circuit Breakers	Yes

Heat Exchanger

*Rated at standard conditions of 35.5° db/24.0° wb

Sensible Poly Media	Standard
Face Velocity (m/sec)	1.9
Pressure Drop (Pa)	56.9
Kw Recovered (Heating)*	8.08

Cabinet Construction

Casing	50mm Insulated Panel
Finish	Surf Mist Colourbond
Insulation Value	R2.0
Side Access Panels	Included
Corrosion Resistant Lining	Included

Design Temperatures

Ambient (DB/WB) Summer	35°C/24°C
Return Air (DB/WB) Summer	24°C/17°C
Ambient Winter	7°C
Return Air Winter	21°C

Coil Selection

Indoor Coil FL x FH (mm)	760 x 482
Face Velocity (m/sec)	2.5
Outdoor Coil FL x FH (mm)	760 x 711
Face Velocity (m/sec)	2.7
Anti-Corrosion Coil Coating	Included
Drain Tray	Stainless Steel

Refrigeration *At standard design temperatures

Heating Capacity (kW)*	18
Cooling Capacity (kW)*	18
Fixed Speed Compressor	Standard - x1 - R407C
Inverter Compressor	Available - x1 - R410A
Expansion Device	TX Biflow Valves
Head Pressure Control	Included

Options

Economy Cycle	Available (XES900P3EC)
Return Air Bypass Damper	Available

Technical Drawings – XES900P3

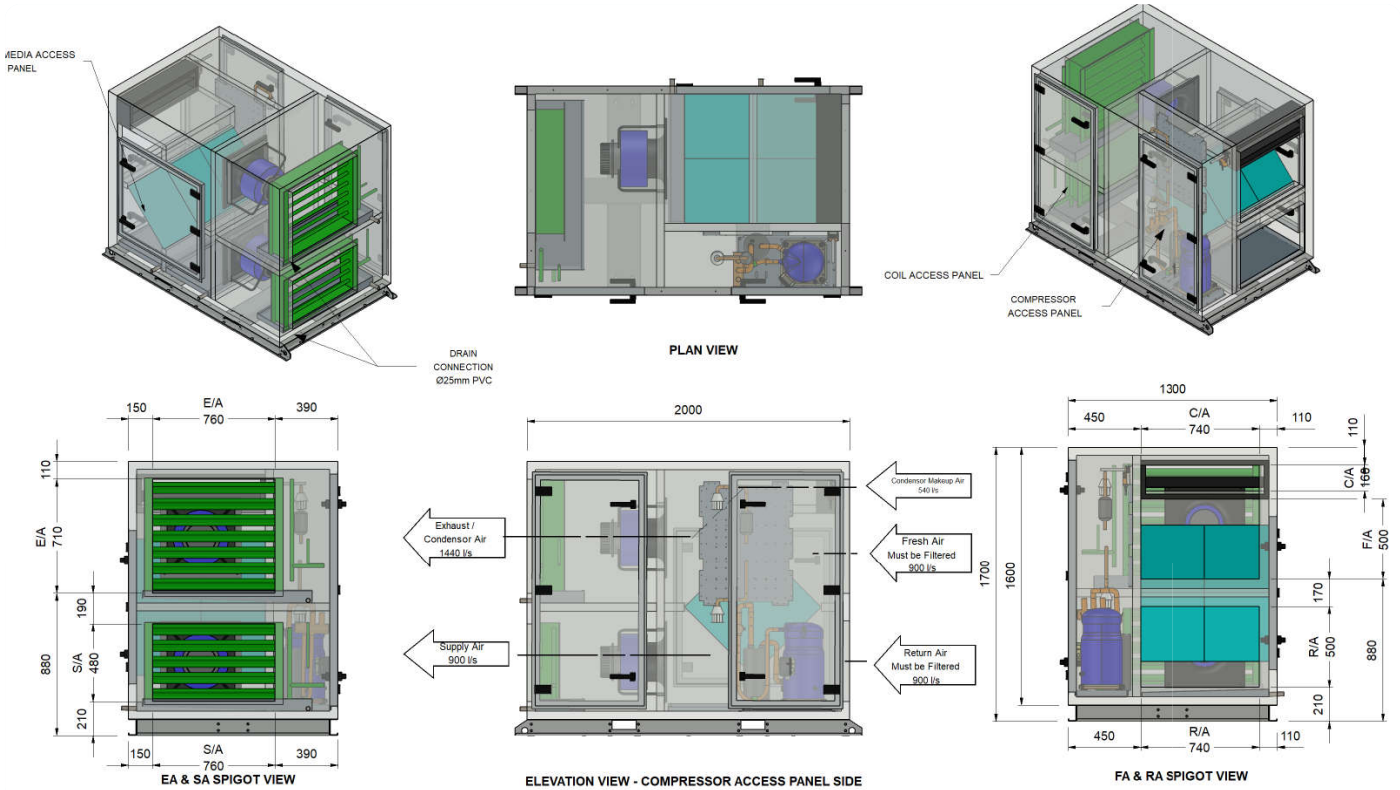

Dimension	
Height (mm)	1700
Width (mm)	1300
Length (mm)	2000
Weight (kg)	615
Access Clearance (mm)	1200 (Fan & Media Access)
Access Clearance (mm)	1200 (Electrical Controls)

Duct Sizes	
Supply Air (mm)	760 x 480
Return Air (mm)	740 x 500
Fresh Air/Condensor Air Inlet	740 x 710
Exhaust/Condensor Air	760 x 710
Recommended min F/A Filter Size	740 x 500

Compressor Performance Data

Compressor Capacity (KW) – Cooling

Return Air Temperatures	Outdoor Coil Entering Air Temperature (E.A.T) °C db											
	23		27		31		35		39		43	
24°C/17°C db/wb	Total	Sens.	Total	Sens.	Total	Sens.	Total	Sens.	Total	Sens.	Total	Sens.
	19.4	15.9	19.1	15.9	18.7	15.8	18.0	15.3	16.7	14.5	15.5	11.2

Compressor Capacity (KW) – Heating

Return Air Temperatures	Outdoor Coil Entering Air Temperature (E.A.T) °C db					
	-1	1	3	5	7	9
22°C	13.9	14.8	15.7	16.9	18.0	18.7

Fan Performance Data

*Duty point - 900 L/s at 700 Pa Total Static Pressure (250Pa External Static Pressure)

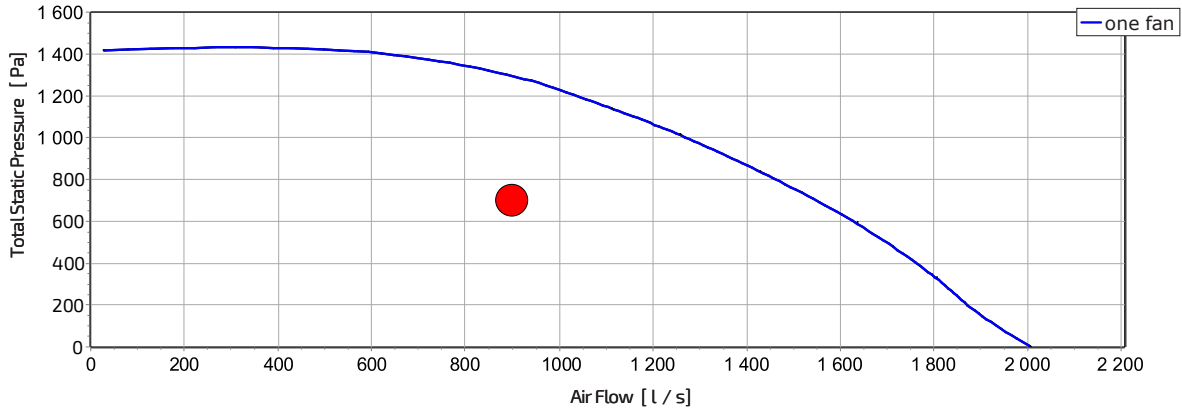

Sound Power Levels

*Sound power levels at 700 Pa Total Static Pressure and 900 L/s Total Air Volume

Inlet Rating dB		Outlet Rating dB	
63 Hz	39.5	63 Hz	41.5
125 Hz	56.9	125 Hz	56.6
250 Hz	65.0	250 Hz	64.7
500 Hz	68.8	500 Hz	71.9
1K Hz	68.8	1K Hz	76.6
2K Hz	70.5	2K Hz	75.5
4K Hz	68.6	4K Hz	74.1
8K Hz	60.9	8K Hz	65.7
LwA	75.9	LwA	81.1

Wiring Diagram

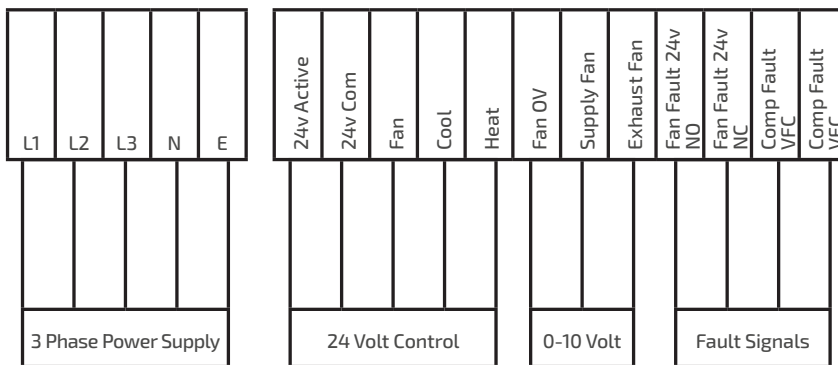

STANDARD INCLUSIONS

- Fan Speed Controller
0-10v DC - BMS Connection, **OR**
24v AC - Fan Speed Control via Pots
- Circuit Breakers
- Time Delay Relay
- Phase Fail Relay
- Reversing Valve
- High Pressure Cutout
- Low Pressure Cutout
- Compressor Overload

OPTIONS

- Compressor Sump Heat
- Current Sensing Relay
- 0-10v Digital Compressor

