

ERV-ENERGY RECOVERY



XEC Chilled/Hot Water Coil Unit

XEC7500P3 Technical Data

Technical Specifications

Nominal Airflow

Supply Air (l/sec)	6100 - 7500
Exhaust Air (l/sec)	6100 - 7500
Return Air (l/sec)	6100 - 7500
Fresh Air (l/sec)	6100 - 7500

Supply Fan

Fan Type	EC Plug
Motor Power (Watts)	4500
External Static (Pa)	250
Fan Diameter	450
Number of Fans	3

Exhaust Fan

Fan Type	EC Plug
Motor Power (Watts)	4500
External Static (Pa)	250
Fan Diameter	450
Number of Fans	3

Electrical

Supply Fan (A)	20.4 - 20.4 - 20.4
Exhaust Fan (A)	20.4 - 20.4 - 20.4
Maximum Full Load (A)	40.8 - 40.8 - 40.8
Volt/Phase	415V/3ph

Controls

0-10V DC (Fan Control)	Included
24V AC Control Relay	Included
Fan Fault Signal	Included
Fan Run Status	Available
Switchboard	Yes
Circuit Breakers	Yes

Heat Exchanger

*Rated at standard conditions of 35.5° db/24.0° wb

Enthalpy Media	Available
Sensible Media	Standard
Face Velocity (m/sec)	1.875
Pressure Drop (Pa)	94
Kw Recovered (Cooling)*	58.2
Kw Recovered (Heating)*	94.8

Cabinet Construction

Casing	50mm Insulated Panel
Insulation Value	R2.0
Side Access Panels	Included

Chilled Water Coil - if required (Nom. rating)

Total Capacity (Kw)	145.0
Max. Size FL x FH (mm)	3740 x 940
Water In (°C)/ Water Out (°C)	7° / 14°
Coil Coating	Epoxy Coating
Face Velocity (m/sec)	2.13
Stainless Steel Drain Tray	Included

Hot Water Coil - if required (Nom. rating)

Total Capacity (Kw)	145.0
Max. Size FL x FH (mm)	3740 x 940
Water In (°C)/ Water Out (°C)	80° / 60°
Coil Coating	Epoxy Coating
Face Velocity (m/sec)	2.13

Options

Economy Cycle	Available
Return Air Bypass	Available
Corrosion Resistant Lining	Available

ERV-ENERGY RECOVERY

XEC Chilled/ Hot Water Coil Unit – XEC7500P3 Technical Data

Technical Drawings – XEC7500P3

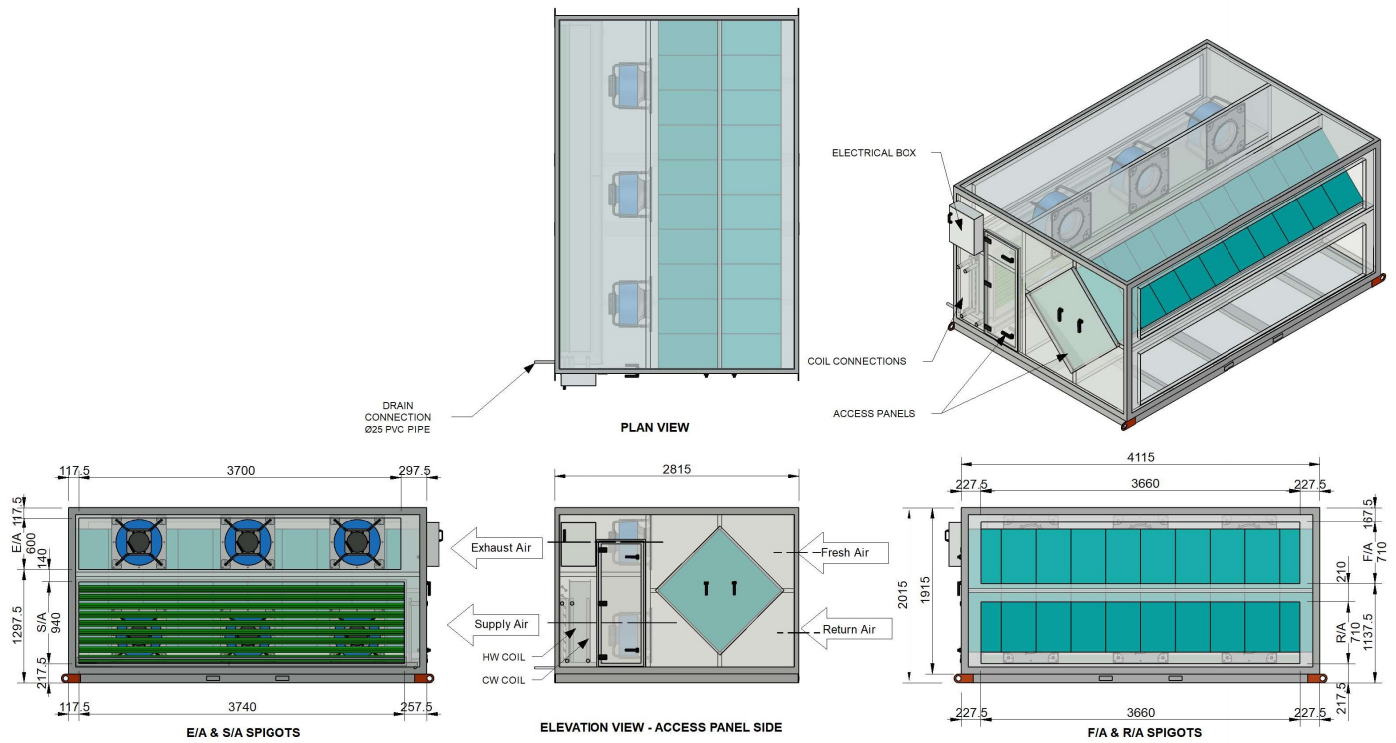

Dimension

Height (mm)	2015
Width (mm)	4115
Length (mm)	2815
Weight (Kg)	2320
Access Clearance (mm)	1200 (Fan & Media Access)

Duct Sizes

Exhaust Air (mm)	3700 x 600
Return Air (mm)	3660 x 710
Supply Air (mm)	3700 x 940
Fresh Air (mm)	3660 x 710

ERV-ENERGY RECOVERY

XEC Chilled/ Hot Water Coil Unit – XEC7500P3 Technical Data



Fan Performance Data

*Duty point - 7500 L/s at 600 Pa Total Static Pressure (250Pa External Static Pressure)

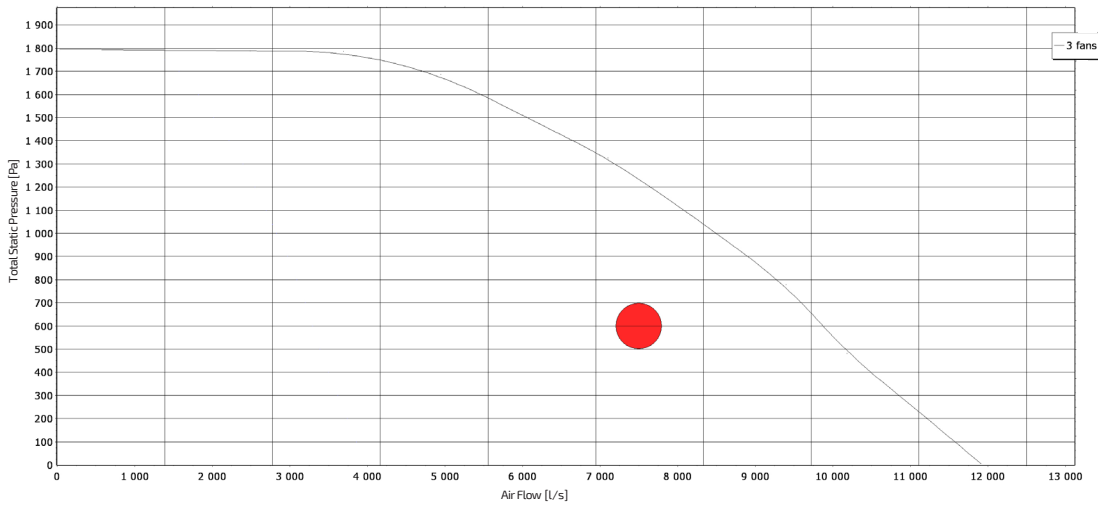

Sound Power Levels

*Sound power levels at 600 Pa Total Static Pressure and 7500 L/s Total Air Volume

Inlet Rating dB		Outlet Rating dB	
63 Hz	67.9	63 Hz	73
125 Hz	79.0	125 Hz	82.9
250 Hz	81.7	250 Hz	81.0
500 Hz	76.7	500 Hz	83.2
1K Hz	78.0	1K Hz	88.6
2K Hz	78.2	2K Hz	83.1
4K Hz	91.0	4K Hz	91.4
8K Hz	75.9	8K Hz	78.9
LwA	92.6	LwA	94.6

Wiring Diagram

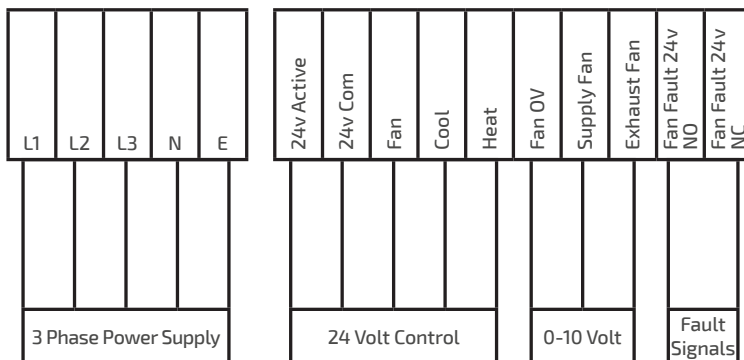

Option 1

0-10V DC CONTROL VIA CONNECTION TO BMS

Option 2

24V AC ENABLE REGULATE FAN SPEED VIA POTS

Do not turn main power on/off to enable/disable the unit operation. This must be done through the control circuit.



A: 109-111 Northcorp Blvd, Broadmeadows VIC 3047
 T: 03 8301 9200
 E: sales@armcor.com.au
 W: armcor.com.au

© 2022 Armcor Air Solutions reserves the right to alter products and specifications without notice and does not accept responsibility for possible errors and omissions in published documentation.
 Date: 24/05/2022 | Document: XEC7500P3_techspec | Version 1